

**mimi moto®**  
clean cooking for all

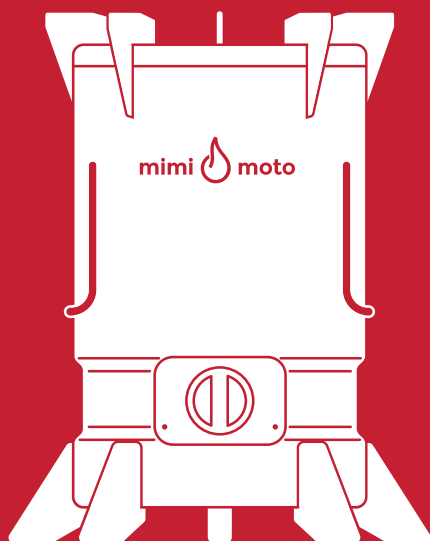

**User Manual**



**For terms and conditions please  
visit: [mimimoto.nl/terms](https://mimimoto.nl/terms)**

*version: 08-2021*

*\* This manual applies to Mimi Moto stoves  
with S/N 310032101 and above.*

Notes	5
Assembly of feet and pan support	6
Notes	7
Lighting and extinguish the stove	8
To continue cooking when only glowing embers are left	10
What if the stove is producing a lot of smoke?	11
Stoves without battery pack	12
Stoves with built-in battery pack	13
Warnings	14

# Components

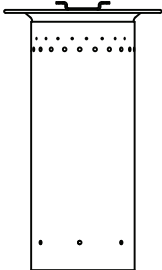
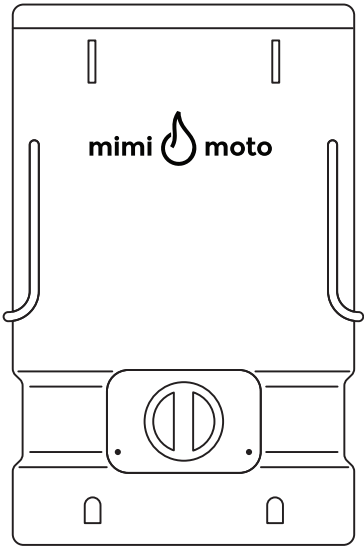

small  
burner



medium  
burner

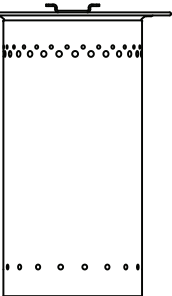

large  
burner



5 feet  
5 clips



5 pan  
supports

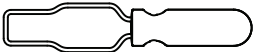

burner handle

## OPTIONAL

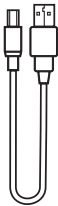

USB cable

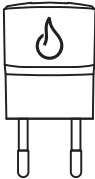

power  
adapter



LiFePO4 3.2V 5000mAh



battery  
pack

[illegible]

# Assembly of feet and pan support

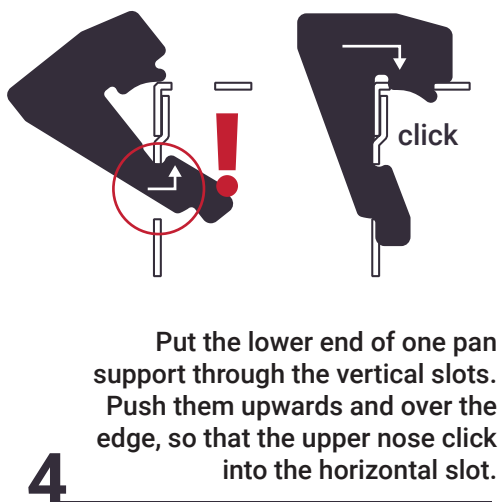
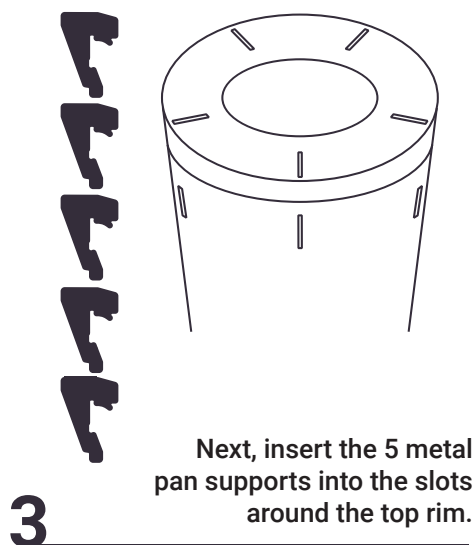
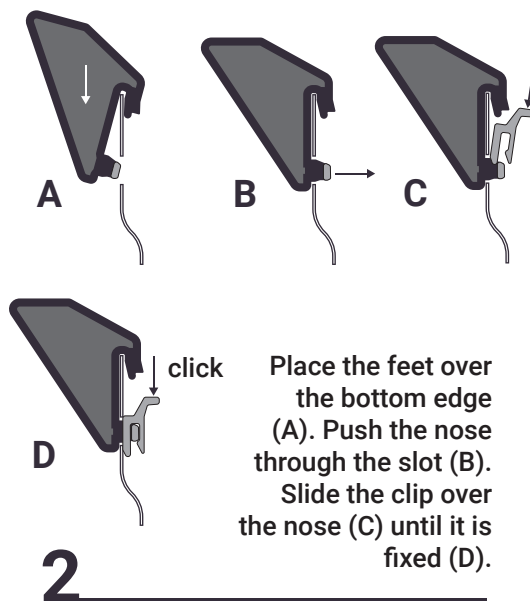
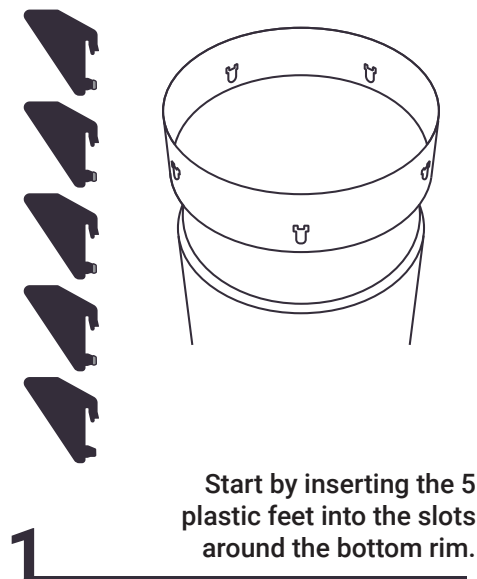

# Notes

-----

-----

-----

-----

-----

-----

-----

-----

-----

-----

-----

-----

-----

-----

-----

-----

-----

-----

-----

# How to Light and extinguish the stove

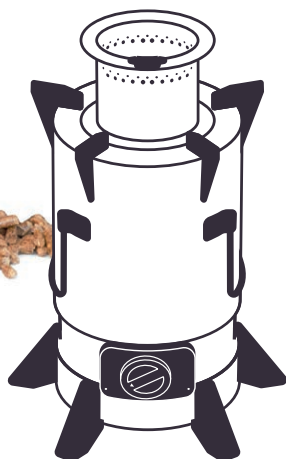

Fill burner with fuel and lighting material and place in stove

1

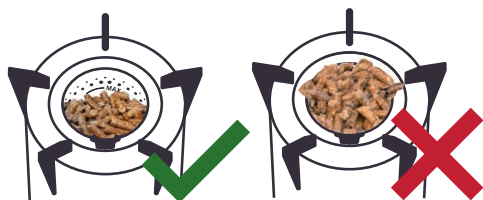

Fill up to the MAX indicator line of the burner



2



Light fire

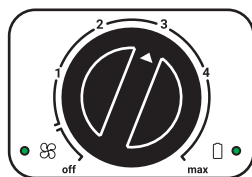
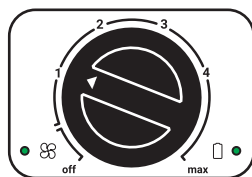

Turn fan on.  
Adjust fan to speed 1 to get a good flame going

When you have a well-burning, circular flame, adjust fan speed to between 3 and 4

3



4





Attention: We recommend that you DO NOT run the fan at it's highest speed!

Maximum fan speed will increase the intensity of airflow, resulting in:

- short battery life
- inefficient flame
- inefficient pellets use
- more pollution

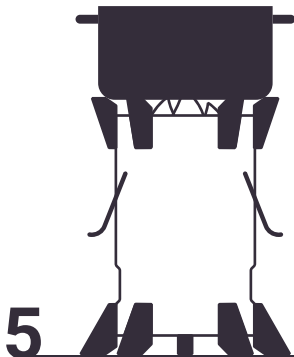
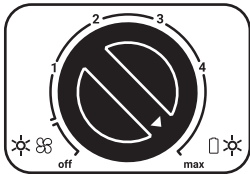

Start cooking

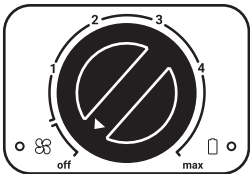

Use stove until all flames have extinguished and only glowing embers are left

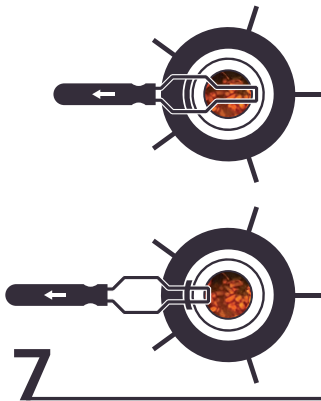

Attach burner handle and remove burner



Empty burner into a fireproof container with lid

# To continue cooking when only glowing embers are left

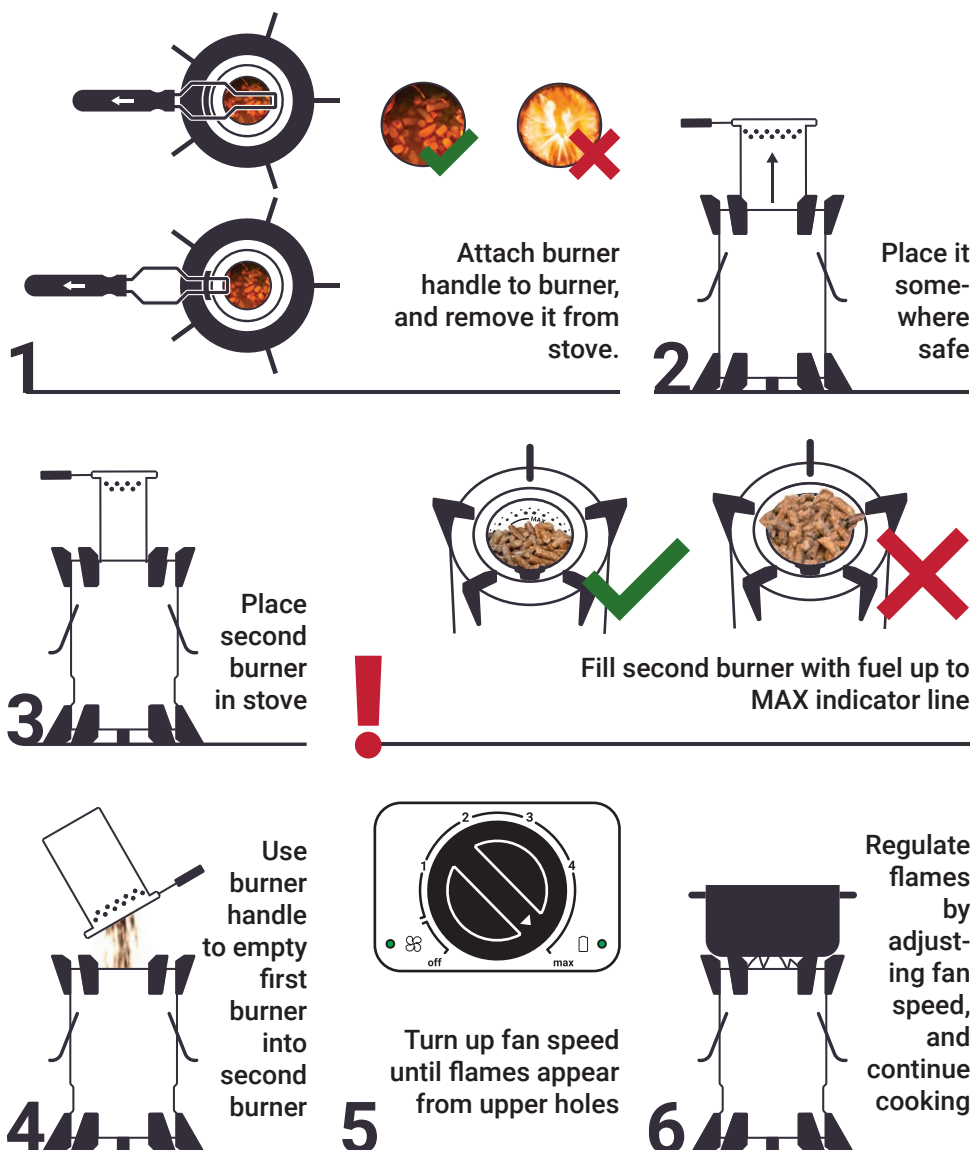

# What if the stove is producing a lot of smoke?

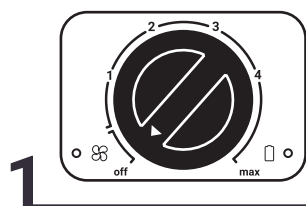
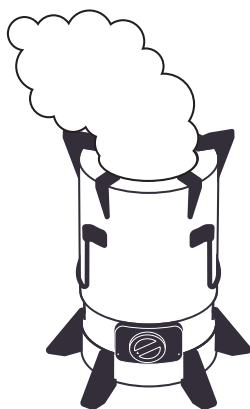

Turn fan  
off, stop  
cooking  
and avoid  
inhaling  
smoke

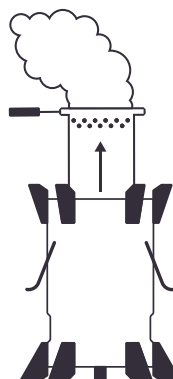

Use burner  
handle and  
carefully lift out  
burner



Place burner outdoors,  
or empty burner into  
a fireproof container  
with lid and place  
outdoors

# Stoves WITHOUT battery pack

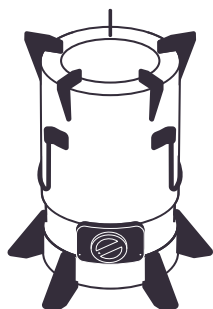

Your stove package includes a USB cable

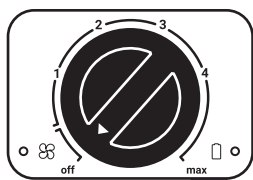

To use fan, plug the USB B end into control panel

1



Plug USB A end into a device with a compatible USB port (phone charger, power bank, etc.)

2

## Led indicator status stove without battery

- ☼ Fan running
- ☐ USB-input (stand-by) knob off
- ☼ ☼ Fan blocked/malfunction
- ☐ Power on
- ☼ Stove off / no power

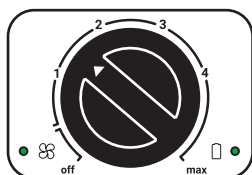

When you turn the fan on, this will be indicated by a green LED light

3

4

# Stoves WITH built-in battery pack

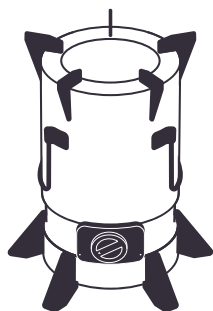

Your stove has a built-in battery pack. The package includes a USB cable.

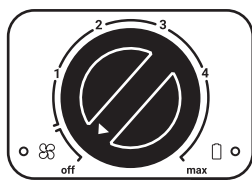

To charge battery, plug USB B end into control panel

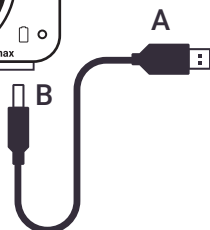

1



Plug USB A end into a wall socket.

2A

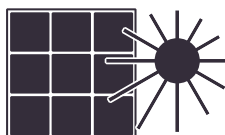

Or plug it into a solar panel that is placed in the sun.

2B

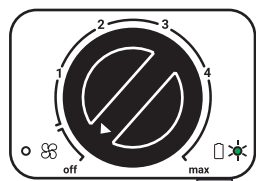

- Charging
- Fully charged

A blinking green LED light indicate the stove is charging. When it turns solid green battery is fully charged

3

## Led indicator status stove with battery

- Fan running
- Battery full (100% - 20%)
- Fan blocked/ malfunction
- Battery low (20% - 10%)
- Stove off / battery empty
- Battery critically low (below 10%) Finish cooking, charge battery

4

# Warnings

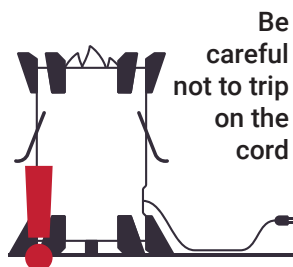

# Warnings



Use of wood pellets as fuel is recommended



Do not use charcoal as fuel

