

mimi moto®
clean cooking for all

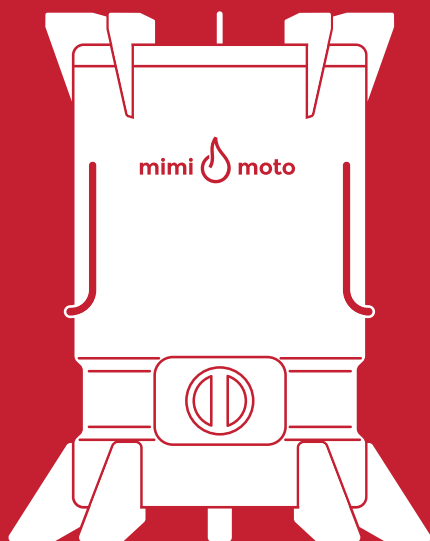

User Manual



**For terms and conditions please
visit: mimi-moto.com/terms**

version: 09-2016

Notes	5
Assembly of feet and pan support	6
Notes	7
Lighting and extinguish the stove	8
To continue cooking when only glowing embers are left	10
What if the stove is producing a lot of smoke?	11
Stoves without battery pack	12
Stoves with built-in battery pack	13
Warnings	14

Components

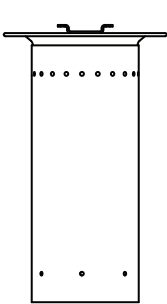
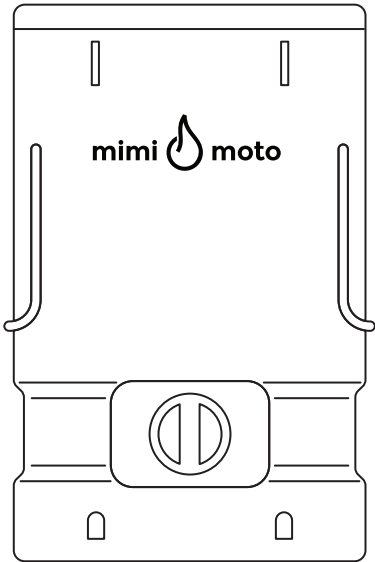

small
burner

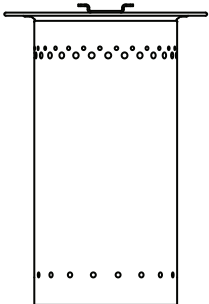

large
burner



5 feet



5 pan
supports

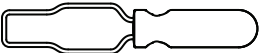

burner handle

OPTIONAL

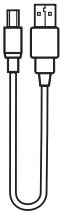

USB cable

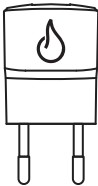

power
adapter

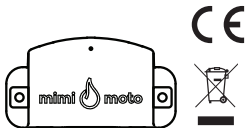

LiFePO4 3.2V 5000mAh

battery
pack

[illegible]

Assembly of feet and pan support

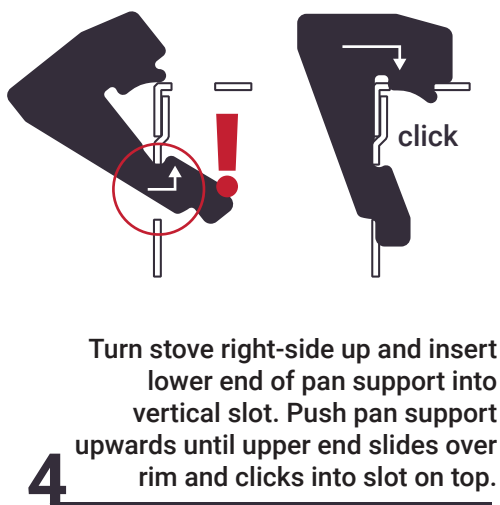
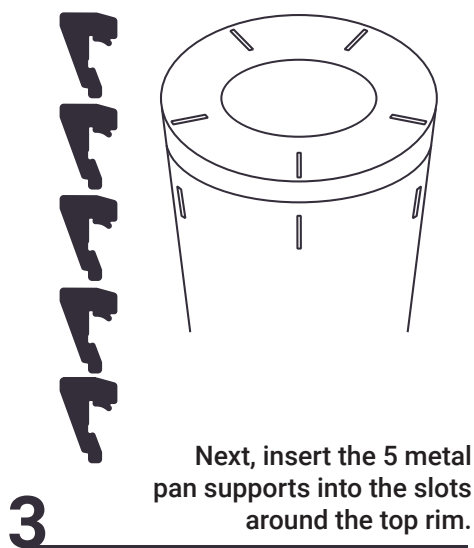
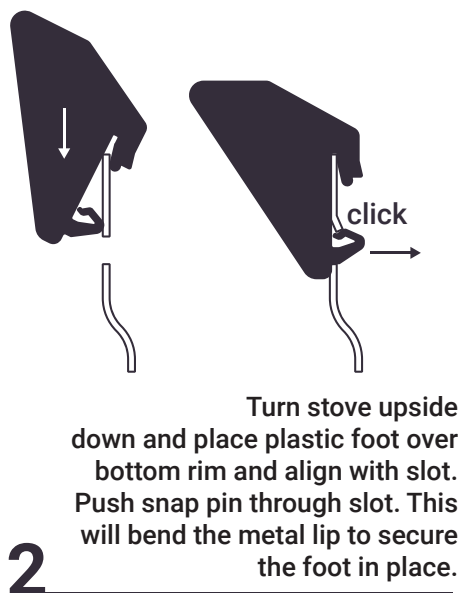
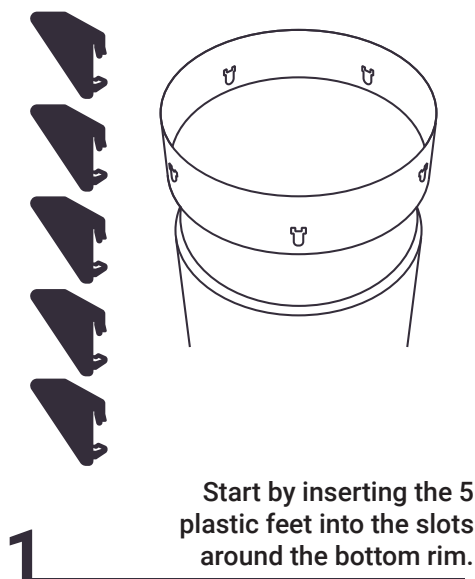

Notes

[illegible]

How to Light and extinguish the stove

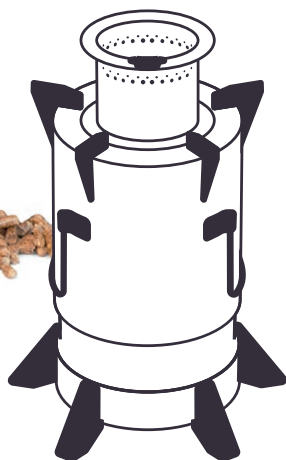

Fill burner with fuel and lighting material and place in stove

1



Leave 1cm between fuel and upper holes of burner



2



Light fire

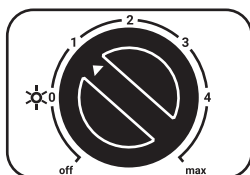

3

Turn fan on. Adjust fan to speed 1 to get a good flame going

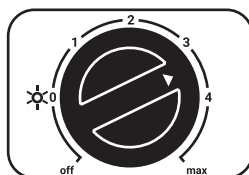

4

When you have a well-burning, circular flame, adjust fan speed to between 3 and 4

Attention: We recommend that you DO NOT run the fan at it's highest speed!

Maximum fan speed will increase the intensity of airflow, resulting in:

- short battery life
- inefficient flame
- inefficient pellets use
- more pollution

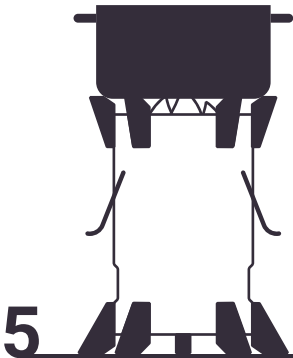

Start cooking

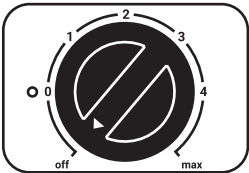

Use stove until all flames have extinguished and only glowing embers are left

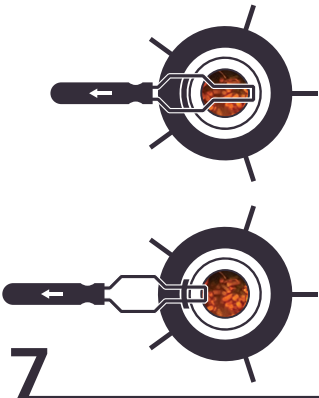

Attach burner handle and remove burner



Empty burner into a fireproof container with lid

To continue cooking when only glowing embers are left

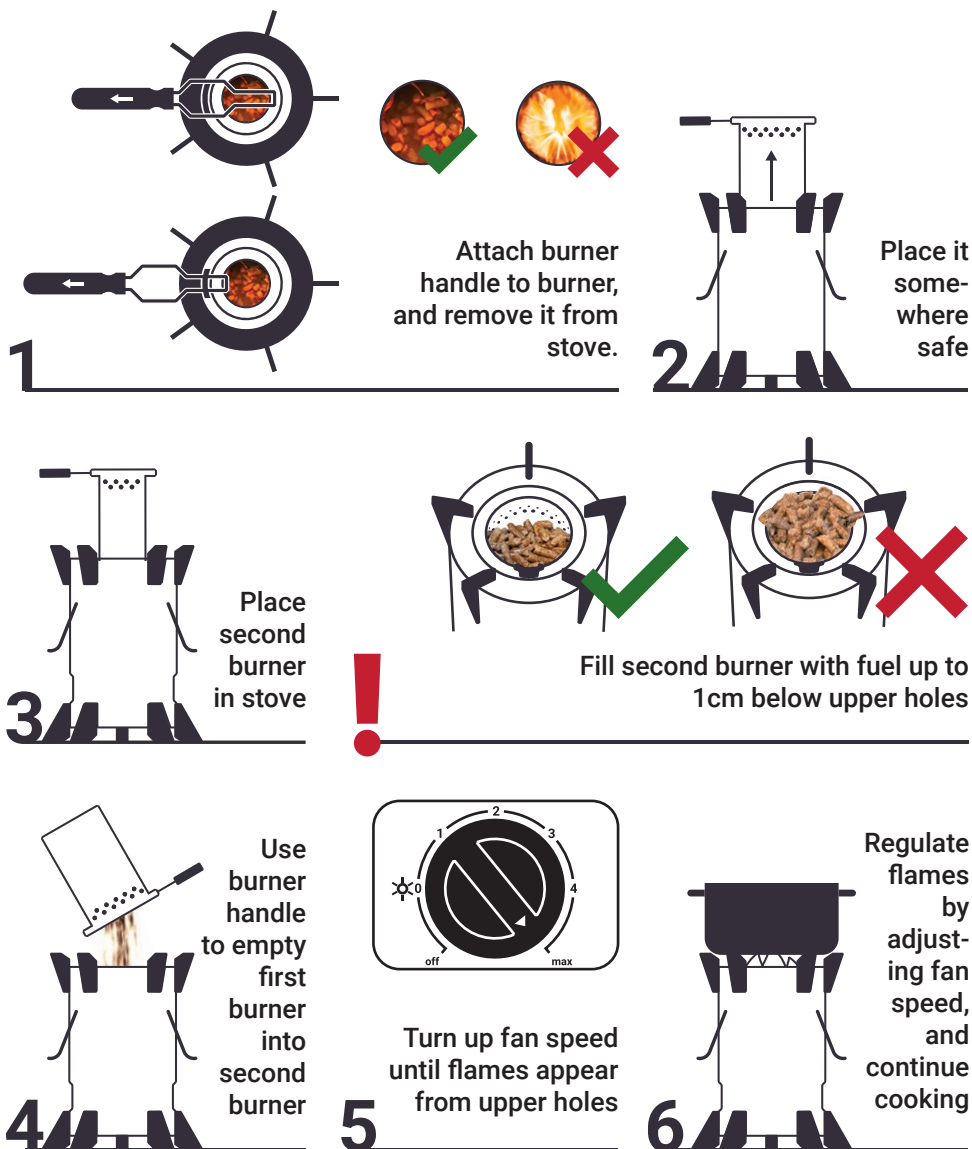

What if the stove is producing a lot of smoke?

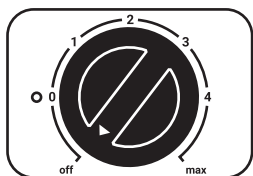
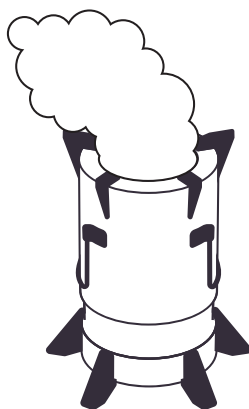

Turn fan
off, stop
cooking
and avoid
inhaling
smoke

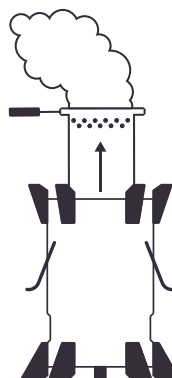

Use burner
handle and
carefully lift out
burner



Place burner outdoors,
or empty burner into
a fireproof container
with lid and place
outdoors

Stoves WITHOUT battery pack

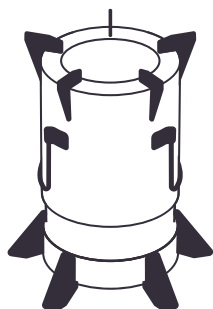

Your stove package includes a USB cable

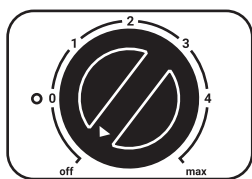

To use fan, plug the USB B end into control panel

1



Plug USB A end into a device with a compatible USB port (phone charger, power bank, etc.)

2

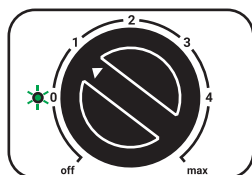

When you turn the fan on, this will be indicated by a green LED light

3

Stoves WITH built-in battery pack

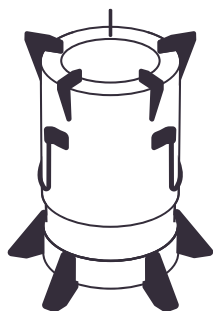

Your stove has a built-in battery pack. The package includes a USB cable.

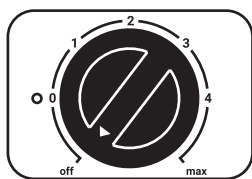

To charge battery, plug USB B end into control panel

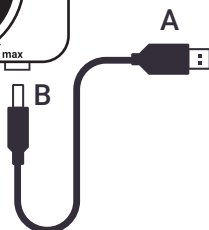

1



Plug USB A end into a wall socket.

2A

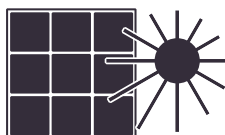

Or plug it into a solar panel that is placed in the sun.

2B

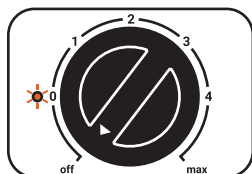

A red LED light indicates battery is charging. When it turns green, battery is fully charged.

3

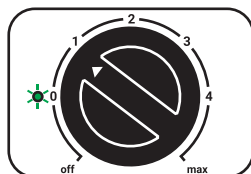

A green LED light indicates fan is running on battery power. When it turns orange, 80% to 20% power remains. When it turns red, less than 20% power remains, and battery should be recharged.

4

Warnings

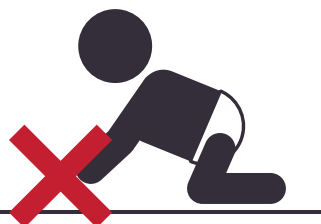
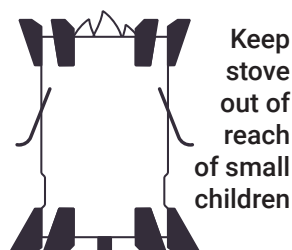
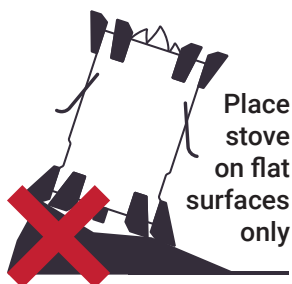

Warnings

